



jordan fishwick

MANCHESTER
Henbury Street



Henbury Street, Manchester, M14 7JE

£175,000



The Property

A spacious, 2 double bedroom terrace property suitable for a number of buyers including first time buyer or professional couple and investors, well placed for Manchester City Centre with excellent transport links in a quiet location. The accommodation comprises: Entrance hall, lounge, separate dining room with French doors opening to the rear courtyard and open plan through to kitchen. To the first floor: Master bedroom with a large window to the front, additional double bedroom and bathroom. Gas central heating is installed, and double glazed windows are installed throughout. There is a courtyard garden to the rear of the property. Viewing is recommended. No chain.

Directions

M14 7JE

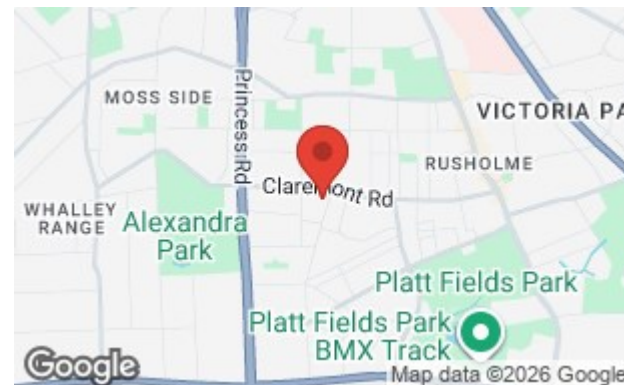

- Two double bedrooms
- Mid terrace
- Fitted kitchen
- Two reception rooms
- Popular residential area
- Gas central heating
- Double glazed throughout
- No chain

Postcode - M14 7JE

EPC Rating - E

Floor Area - 769.00 sq ft

Local Authority - Manchester City Council

Council Tax - A



GROUND FLOOR
384 sq.ft. (35.7 sq.m.) approx.

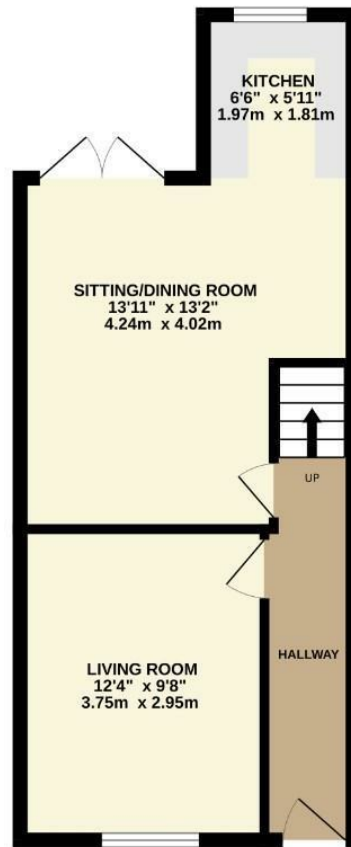

1ST FLOOR
384 sq.ft. (35.7 sq.m.) approx.

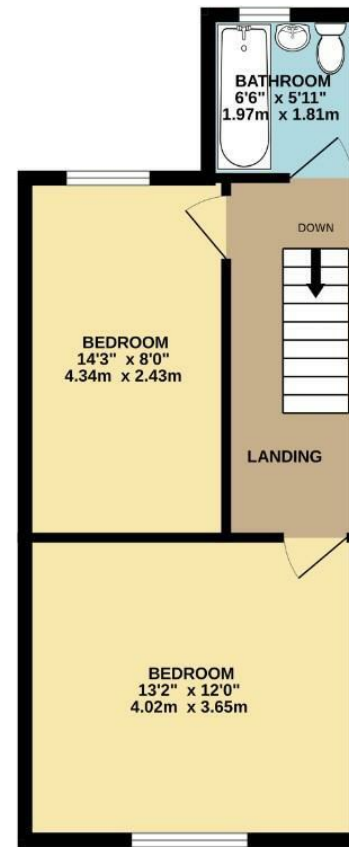

TOTAL FLOOR AREA: 769 sq.ft. (71.4 sq.m.) approx.
Measurements are approximate. Not to scale. Illustrative purposes only.
Made with Metropix ©2026



These particulars are believed to be accurate but they are not guaranteed and do not form a contract. Neither Jordan Fishwick nor the vendor or lessor accept any responsibility in respect of these particulars, which are not intended to be statements or representations of fact and any intending purchaser or lessee must satisfy himself by inspection or otherwise as to the correctness of each of the statements contained in these particulars. Any floorplans on this brochure are for illustrative purposes only and are not necessarily to scale.

Offices also at: Wilmslow, Macclesfield, Hale, Sale, Chorlton, Glossop, Manchester & Salford

757-759 Wilmslow Road, Didsbury Village, Manchester

0161 445 4480

didsbury@jordanfishwick.co.uk
www.jordanfishwick.co.uk